

Adjustable hand reamers



011010

right-hand cutting, straight flutes, with cylindrical shank and square end (wrench size SW please see below)

adjustment range approx. 1/100 of the diameter (e.g. reamer \varnothing 5 mm = adjustable by 0,05 mm)

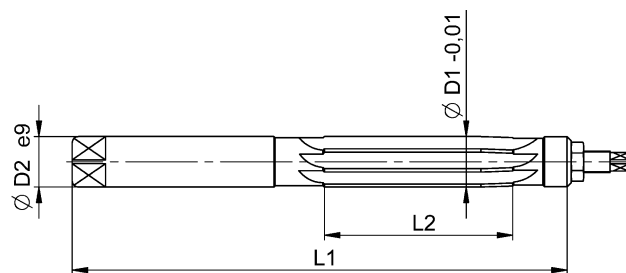
DIN 859	Type A	HSS
---------	--------	-----

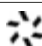

	Steel <900 N ★	Steel 900-1400N ★	VA Stainless steel	GG ★	GGG ★	GGG >GGG50	Cu/Zn/Mg ★	Alu ★	Ti	HRC < 63 HRC	Group 1	 vc / f
--	-----------------------------	--------------------------------	------------------------------	----------------	-----------------	----------------------	----------------------	-----------------	-----------	------------------------	-------------------	---

Ø D1 mm		Ø-range mm	L1 mm	L2 mm	Ø D2 mm	SW mm	
4.00	●	3.90 - 4.20	76	24	4	3	6
4.50	●	4.21 - 4.70	81	27	4.5	3.4	6
5.00	●	4.71 - 5.20	87	30	5	3.8	6
5.50	●	5.21 - 5.70	93	33	5.5	4.3	6

- Ex stock, subject to being unsold
- Delivery on short notice

For special tolerances and intermediate diameters also delivery on short notice.

2



Adjustable hand reamers

011011

right-hand cutting, left-hand spiral flutes, with cylindrical shank and square end (wrench size SW please see below)

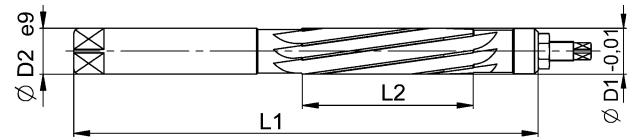
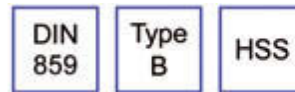
adjustment range approx. 1/100 of the diameter (e.g. reamer Ø 20 mm = adjustable by 0,2 mm)



	Steel <900 N	Steel 900-1400N	VA Stainless steel	GG	GGG	GGG >GGG50	Cu/Zn/Mg	Alu	Ti	HRC < 63 HRC	Group	 vc / f
	★	★		★	★		★	★			1	

2

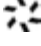
Ø D1 mm		Ø-range mm	L1 mm	L2 mm	Ø D2 mm	SW mm	
6.00	●	5.70 - 6.20	93	33	6	4.9	6
6.50	●	6.21 - 6.70	100	34	6.5	4.9	6
7.00	●	6.71 - 7.20	107	38	7	5.5	9
7.50	●	7.21 - 7.63	107	38	7.5	6.2	9
8.00	●	7.64 - 8.20	115	42	8	6.2	9
8.50	●	8.21 - 8.63	115	42	8.5	7	9
9.00	●	8.64 - 9.20	124	46	9	7	9
9.50	●	9.21 - 9.63	124	46	9.5	8	9
10.00	●	9.64 - 10.20	133	50	10	8	9
10.50	●	10.21 - 10.60	133	50	10.5	8	9
11.00	●	10.61 - 11.20	142	51	11	9	9
11.50	●	11.21 - 11.80	142	51	11.5	9	9
12.00	●	11.81 - 12.40	152	56	12	9	9
12.50	●		152	56	12.5	10	9
13.00	●	12.41 - 13.20	152	56	13	10	9
13.50	●	13.21 - 13.64	163	61	13.5	11	9
14.00	●	13.65 - 14.14	163	61	14	11	9
14.50	○	14.15 - 14.64	163	61	14.5	11	9
15.00	●	14.65 - 15.14	163	61	15	12	9
15.50	○	15.15 - 15.64	175	67	15.5	12	9
16.00	●	15.65 - 16.14	175	67	16	12	9
16.50	○	16.15 - 16.64	175	67	16.5	13	9
17.00	●	16.65 - 17.14	175	67	17	13	9
17.50	○	17.15 - 17.64	188	68	17.5	14.5	9
18.00	●	17.65 - 18.14	188	68	18	14.5	9
18.50	○	18.14 - 18.40	188	68	18.5	14.5	9
19.00	●	18.41 - 19.16	188	68	19	14.5	9
19.50	○	19.17 - 19.66	201	75	19.5	16	9
20.00	●	19.67 - 20.16	201	75	20	16	9
21.00	○	20.17 - 21.20	201	75	21	16	9
22.00	●	21.21 - 22.20	215	82	22	18	12
23.00	○	22.21 - 23.20	215	82	23	18	12
24.00	●	23.21 - 24.20	231	85	24	18	12
25.00	●	24.21 - 25.20	231	85	25	20	12
26.00	●	25.21 - 26.20	231	85	26	20	12

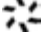
Ø D1 mm		Ø-range mm	L1 mm	L2 mm	Ø D2 mm	SW mm	
27.00	○	26.21 - 27.20	247	94	27	22	12
28.00	●	27.21 - 28.20	247	94	28	22	12
29.00	○	28.21 - 29.20	247	94	29	22	12
30.00	●	29.21 - 30.20	247	94	30	24	12
31.00	○	30.20 - 31.20	265	99	31	24	12
32.00	●	31.20 - 32.20	265	99	32	24	12
33.00	○	32.20 - 33.20	265	99	33	26	12
34.00	○	33.21 - 34.20	284	108	34	26	12
35.00	●	34.21 - 35.20	284	108	35	29	12
36.00	●	35.21 - 36.20	284	108	36	29	12
37.00	○	36.21 - 37.20	284	108	37	29	12
38.00	●	37.21 - 38.20	305	111	38	29	12
39.00	○	38.21 - 39.20	305	111	39	32	12
40.00	●	39.21 - 40.20	305	111	40	32	12
41.00	○	40.21 - 41.20	305	111	41	32	12
42.00	○	41.21 - 42.20	305	111	42	32	12
43.00	○	42.21 - 43.20	326	120	43	35	12
44.00	○	43.21 - 44.20	326	120	44	35	12
45.00	●	44.21 - 45.20	326	120	45	35	12
46.00	○	45.21 - 46.20	326	120	46	35	12
47.00	○	46.21 - 47.20	326	120	47	39	12
48.00	○	47.21 - 48.20	347	131	48	39	12
49.00	○	48.21 - 49.20	347	131	49	39	12
50.00	●	49.21 - 50.20	347	131	50	39	12
51.00	○	50.21 - 51.20	347	131	51	39	16
52.00	○	51.21 - 52.20	347	131	52	39	16
53.00	○	52.21 - 53.20	347	131	53	44	16
54.00	○	53.21 - 54.20	367	134	54	44	16
55.00	●	54.21 - 55.20	367	134	55	44	16
56.00	○	55.21 - 56.20	367	134	56	44	16
57.00	○	56.21 - 57.20	367	134	57	44	16
58.00	○	57.21 - 58.20	367	134	58	44	16
59.00	○	58.20 - 59.20	367	134	59	49	16
60.00	●	59.21 - 60.20	367	134	60	49	16

- Ex stock, subject to being unsold
- Delivery on short notice

For intermediate diameters and special tolerances also delivery on short notice.